

## HOW TO HANDRUB?

### RUB HANDS FOR HAND HYGIENE! WASH HANDS WHEN VISIBLY SOILED

 Duration of the entire procedure: 20-30 seconds



**1a** Apply a palmful of the product in a cupped hand, covering all surfaces;

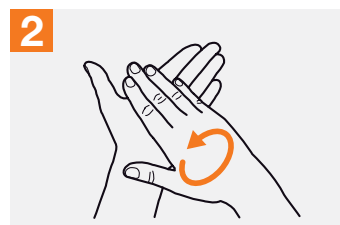

**2** Rub hands palm to palm;

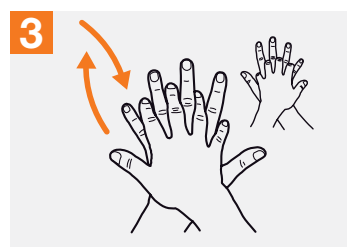

**3** Right palm over left dorsum with interlaced fingers and vice versa;



**4** Palm to palm with fingers interlaced;



**5** Backs of fingers to opposing palms with fingers interlocked;



**6** Rotational rubbing of left thumb clasped in right palm and vice versa;

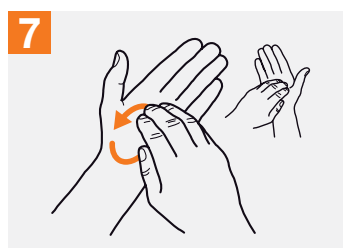

**7** Rotational rubbing, backwards and forwards with clasped fingers of right hand in left palm and vice versa;

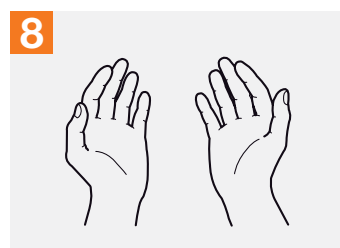

**8** Once dry, your hands are safe.

## HOW TO HANDWASH?

### WASH HANDS WHEN VISIBLY SOILED! OTHERWISE, USE HANDRUB

 **Duration of the entire procedure: 40-60 seconds**

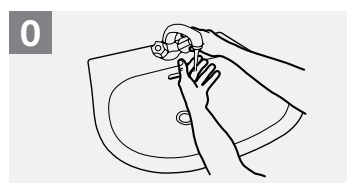

0 Wet hands with water;

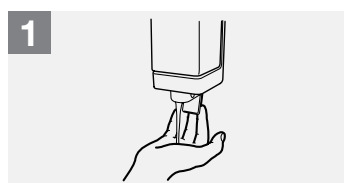

1 Apply enough soap to cover all hand surfaces;

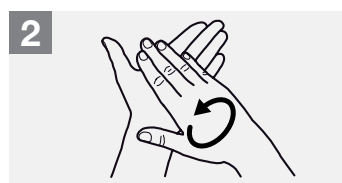

2 Rub hands palm to palm;

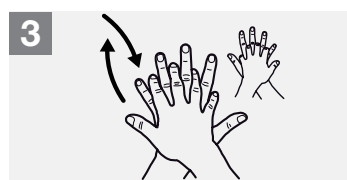

3 Right palm over left dorsum with interlaced fingers and vice versa;

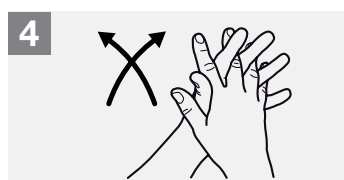

4 Palm to palm with fingers interlaced;

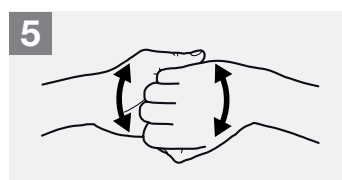

5 Backs of fingers to opposing palms with fingers interlocked;

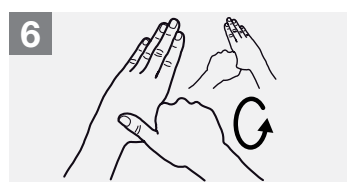

6 Rotational rubbing of left thumb clasped in right palm and vice versa;



7 Rotational rubbing, backwards and forwards with clasped fingers of right hand in left palm and vice versa;

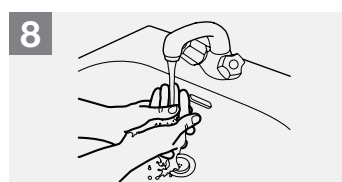

8 Rinse hands with water;

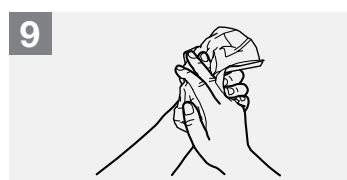

9 Dry hands thoroughly with a single use towel;

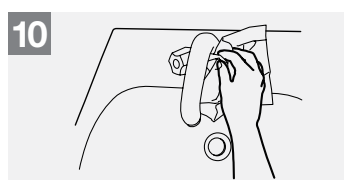

10 Use towel to turn off faucet;

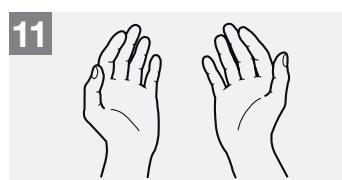

11 Your hands are now safe.

### Hand care

- Take care of your hands by regularly using a protective hand cream or lotion, at least daily.
- Do not routinely wash hands with soap and water immediately before or after using an alcohol-based handrub.
- Do not use hot water to rinse your hands.
- After handrubbing or handwashing, let your hands dry completely before putting on gloves.

### Please remember

- Do not wear artificial fingernails or extenders when in direct contact with patients.
- Keep natural nails short.

## WHEN?

### YOUR 5 MOMENTS FOR HAND HYGIENE\*

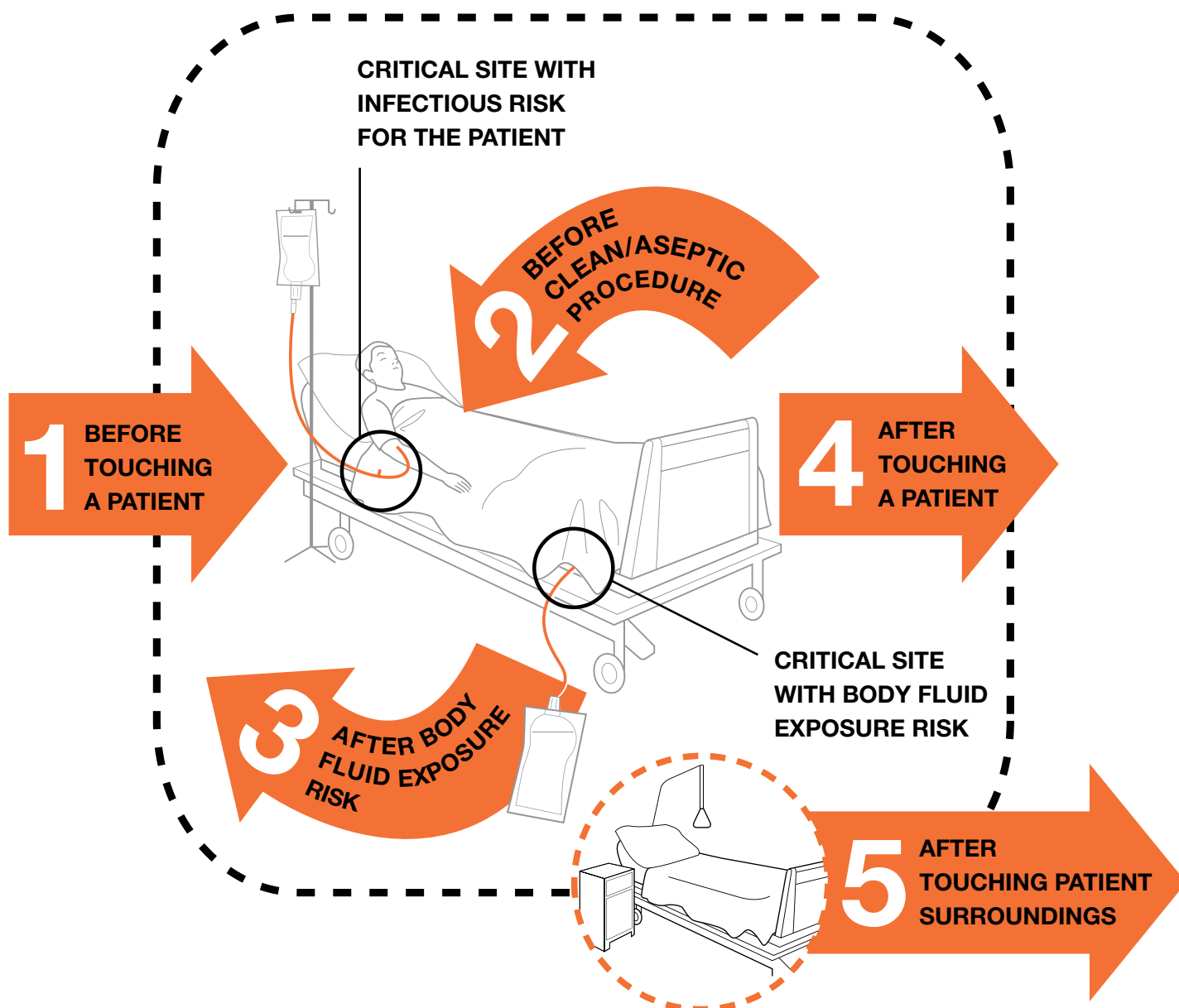

\*NOTE: Hand hygiene must be performed in all indications described regardless of whether gloves are used or not.